



COMMERCIAL PLASTIC SEATS

MODEL 1955CTFR

- ELONGATED SEAT, OPEN FRONT LESS COVER
- SOLID PLASTIC
- DURAGUARD® ANTIMICROBIAL AGENT
- STA-TITE®, COMMERCIAL FASTENING SYSTEM™



DuraGuard®  
ANTIMICROBIAL

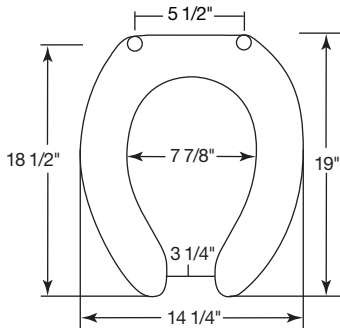

Ring thickness is 13/16"  
Ring thickness including the bumper is 1"  
Height of seat is 2-1/4"

Seats shall be No. \_\_\_\_\_ as manufactured by Church seats. Seats shall contain DuraGuard®, an antimicrobial agent. Seats shall contain FirePro™, a fire retardant material to meet UL-94VO flammability rating. Seats shall be heavy weight and injection molded of solid plastic. Seats shall be open front less cover for elongated bowl and feature large mold-ed-in bumpers. Seats shall have STA-TITE®, Commercial Fastening System™, featuring concealed check hinges with 300 Series stainless steel posts and pintles that stop seat 11 degrees beyond vertical. Color to be white.

Hinges shall be 1955CTFR / 1955SSTFR.  
(Circle model based on description below.)

**1955CTFR** Concealed check hinge stops seat 11° beyond vertical.

**1955SSTFR** Self-sustaining, concealed stainless steel check hinge holds seat in any raised position up to 11° beyond vertical.



STA-TITE®

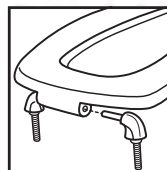

Assemble hinges.

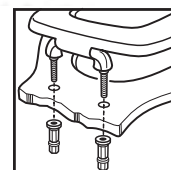

Finger-tighten fastening nuts.

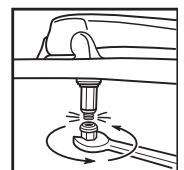

Using wrench, tighten until lower portion shears off.